

# Hallway Happenings



September 2025 Issue 32

Litchfield Public Schools – PO Box 167 Litchfield, NE 68852

Phone: 308.446.2244 – Fax: 308.244.6608



## Elementary State Fair, Testing, and Preschool's First Day

It's always a busy first full week of school. We knocked out some beginning-of-year testing before the Elementary went on their annual trek around the State Fair -- "Nebraska's Largest Classroom."

But it never feels like we've truly started another year until preschool begins. On Monday 8/25, they showed for Day 1. No one has a harder or more exciting transition in their life at school than our first-time preschool kids. But no matter how smooth the first day is, they always get right into the swing of things with centers, recess, rest times, and a ton of learning. Perhaps more than I'd ever seen recently, this year's group showed up with no tears and just excitement! -- *Mr. Moser*

## What Have You Enjoyed and Been Looking Forward to This Year?

Joy, Kinder.: Playing

Ezra, Kinder.: Building with more Legos

Bella Taylor, 1st: Math and friends!

Wyatt Fletcher, 3rd: Learning and recess

Emmy Wright, 3rd: Recess and learning math

Hudson Varah, 4th: PE

Kesslyn Kusek, 4th: Art and Christmas

Kaycee, 5th: Reading books

Ashlynn, 5th: Volleyball and friends

Kenna, 5th: Helping JH sports after school

Bentley, 5th: Learn more!

# Clubs & Organizations

## **FFA Update**

*By James Fletcher, Executive Vice President*

Litchfield FFA: An Unforgettable Year Ahead.

The Litchfield FFA Chapter is officially back in session, and we are looking forward to an impactful and productive year. Our officers are already demonstrating exceptional leadership, setting a strong example for all our members.

A special thank you to our members for their outstanding service at the Town & Country Bank Appreciation Dinner in Pleasanton. Their professionalism while assisting with ice cream and popcorn service was a true testament to our chapter's commitment to community engagement and service.

The recent FFA & FBLA Kickoff was also a resounding success. This event provided a wonderful opportunity for our members to build camaraderie through a friendly game of kickball and network with peers. It was a great way to start the school year and build excitement for the upcoming activities.

For our freshman members, be on the lookout for more information about the upcoming IGNITE Conference. This event is designed to help you develop your leadership skills and gain a deeper understanding of the opportunities available through FFA.

We are confident that this will be a year of significant growth and achievement for our chapter. We look forward to seeing you at our upcoming events!

## **Important Dates: Mark Your Calendars**

We have a busy month ahead, and we encourage all members to participate in these key events:

- **September 3rd: Range Judging** - Join us as we evaluate rangeland resources and apply classroom knowledge in a practical setting.
- **September 9th: Husker Harvest Days** - This is a fantastic opportunity to explore cutting-edge agricultural technology and network with industry leaders.

## **FBLA Update**

*By Ava Paitz, FBLA Reporter*

Our Litchfield FBLA chapter has already been busy kicking off the school year. We had a great turnout for our FBLA and FFA Back to School Bash, which brought members together for food, fun, and fellowship. On Sunday, August 17th, members also teamed up with FFA for our HWY 2 community service project.

Looking ahead, the FBLA Fall Leadership Conference is just around the corner and our chapter is getting ready! This event is a fantastic opportunity for members to dive into engaging workshops on leadership, competitive events, and career development. It's also the perfect chance to meet and network with FBLA members from across Nebraska.

# Athletics

## Fall Sports Previews

*By Caydence Feldman and Ava Paitz*

**Football.** The Ansley-Litchfield 6-man football season kicks off Friday, August 29, with the home opener against Sumner-Eddyville-Miller. This year, they have a young squad with only 2 seniors on the team. While this season may present some challenges, the players and coaches are eager to see improvements with each game. It's a stepping stone toward a stronger future, and everyone is looking forward to seeing what this season will bring.

**Volleyball.** The Ansley-Litchfield volleyball team is excited for the season ahead as it begins with a triangular in Amherst on Thursday, August 28. The team hopes to build on the successes from last year, including Axtell tournament champions, FKC Runner-up, and district runner-up. With only 1 senior last year, the team this season remains strong and determined to keep improving. Their enthusiasm and dedication promise an exciting year ahead as they strive for continued success.







## SPRIT BLANKET FUNDRAISER

Contact a Litchfield FBLA member to purchase  
August 27-September 19

**LITCHFIELD FBLA FUNDRAISER**

**ANSLEY-LITCHFIELD BLANKET**

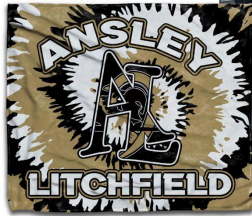

**\$35**

1/1

## LITCHFIELD FBLA CORNHOLE BOARD RAFFLE

WINNER WILL BE NOTIFIED IN DECEMBER

**GRAND PRIZE**  
A SET OF BRAND  
NEW CORN HOLE  
BOARDS-USA  
THEME

**1 TICKET  
FOR \$5 OR  
5 TICKETS  
FOR \$20**

TALK TO AN FBLA MEMBER OR EMAIL US  
AT [FBLA@LITCHFIELDPS.ORG](mailto:FBLA@LITCHFIELDPS.ORG)

All proceeds go to Litchfield FBLA.

# GAME DAY

Sponsored by  
Litchfield FBLA

## SPARTAN YARD LINES

Purchase an A-L Spartan yard line and own it for the four  
VARSITY HOME football games throughout the 2025 season.

If the ball is marked on your yard line at the end of the 1st,  
2nd, 3rd, or 4th quarters, you win \$75.

**\$25/YARD LINE**

**16 CHANCES TO WIN**

Yard lines will be assigned at random. If you're  
feeling lucky...pick your yardline for \$40. First  
come first serve.

Yard lines determined by the discrepancy of the PA announcer.

Yard lines chosen as: Litchfield W ## AND Ansley N ##  
Litchfield E ## AND Ansley S ##

Both goal lines are available for sale

PLEASE MESSAGE THE LITCHFIELD FBLA FACEBOOK PAGE,  
CALL (308) 446-2244, OR EMAIL [FBLA@LITCHFIELDPS.ORG](mailto:FBLA@LITCHFIELDPS.ORG)  
**PAYMENT MUST BE RECEIVED ON OR BEFORE THE START OF THE NEXT HOME GAME**

## Spartan PAVILION

Building on a proud tradition, it's time for the  
next major upgrade at the Litchfield Ball  
Field. The Litchfield School and Community  
thank those who have invested in past  
projects, and are now asking our current  
generation to invest with the construction  
of a new **Spartan Pavilion**.

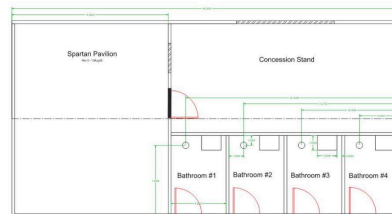

### Spartan Pavilion:

This project would  
include a new  
concession area with  
updated plumbing and  
electric, as well as four  
new bathrooms and a  
porch area for tables.



Concept for visual only

**Spartan  
PAVILION  
INVESTMENT  
LEVELS**

**\$10,000  
\$5,000  
\$1,000  
\$500**

Whether you're a proud alum, a local business, or a community member who loves  
our Spartan teams, your contribution will make a lasting impact.  
If you are interested investing in this project in any way, please contact  
Mitch Feldman at 308-390-4656.

08/14/2025 02:33 PM

Posted - All; Fund Number 01; Processing Month 08/2025

User ID: TDF

Vendor Name	Vendor Description	Amount
Checking Account ID 1	Fund Number 01 GENERAL FUND	
ALL STAR AUTO GLASS		489.42
ANSLEY LUMBER AND SUPPLY		118.95
Ansley Public Schools		16,250.56
Axmann Heating & Air Conditioning		571.00
Beaver Bearing Co		138.45
BLACK HILLS ENERGY		174.58
Custer Public Power		3,563.00
DAS STATE ACCOUNTING - CENTRAL FINANCE		400.19
DREW, MATT		210.38
EAKES OFFICE SOLUTION		175.70
Educational Service Unit 10		767.55
ESU Coordinating Council		1,500.16
FIRST CARE MEDICAL PC OF KEARNEY		185.00
HAMILTON		133.19
HOMETOWN LEASING		341.51
INNOVATIVE OFFICE SOLUTIONS LLC		289.51
INTEGRATED SECURITY SOLUTIONS		423.00
Island Supply Welding Co.		2,439.35
JOURNEYED.COM, INC. DBA JOURNEYED		2,076.84
KEARNEY TOWING		657.86
LIPS PRINTING SERVICE		192.41
Loup Valley Lighting, Inc		172.20
NATIONAL ART & SCHOOL SUPPLIES		26.04
Ne Council School Administrat		435.00
NICHOLS REPAIR INC.		1,285.64
Pep Co., Inc		650.00
PETTY CASH FUND		2,353.08
PRO-ED INC		1,319.90
QUESTIVITY INC		654.30
RAMSEY SOLUTIONS		105.00
Sherman County Times		7.00
SHERWIN WILLIAMS CO, THE		183.47
TCI		11,010.45
Teaching Strategies, LLC		269.00
U.S. BANK		1,195.65
US FOODS		1,561.12
Village Of Litchfield		661.89
WEX BANK		286.24
Yanda's Music		1,068.31
Fund Number 01		54,342.90
Checking Account ID 1		54,342.90

LITCHFIELD PUBLIC SCHOOLS  
BOARD OF EDUCATION  
REGULAR MEETING  
August 18, 2025

President Mitch Feldman called the regular meeting to order at 7:31 p.m.

Members Present: Mitch Feldman, Cole Lewandowski, April Gross, Marie Sweley, Katie Slack, and Alyssa Reynolds.

Visitors:

President Mitch Feldman announced and informed the public that a current copy of the Open Meeting Law is posted on the wall of the meeting room and indicated the instructions for those who wish to speak during public forum.

April Gross moved and Katie Slack seconded to approve board minutes from last month's meeting. Motion carried 6-0.

April Gross gave the treasurer report as General Fund Statement beginning balance of \$1,261,281.00, general funds receipts \$19,649.41, and actual cash available in general fund \$1,015,254.54 in the district treasury. Payroll and claims in the amount of \$238,669.49 were presented for payment. Alyssa Reynolds moved, and Marie Sweley seconded the approval of payment of monthly claims. Motion carried 6-0.

Brian Moser gave the principal's report; In-Service and Workshops, Beginning of Year Kickoff and First Days, New Staff, Upcoming events, and Doors/Security/Tech.

Matt Drew gave an AD Report, and action items; Fall Sports numbers, FKC meeting last Wednesday, all coaches are up to date on CPR training & NFHS course, fall sports athletes are taking concussion tests, and upcoming athletic events, Policy review, approval of Substitute Teacher Pay, Building and Grounds, and Budget Presentation.

Cole Lewandowski moved, and Marie Sweley seconded to approve the review of Policies  
902.05,903.06,903.07,903.08,903.09,904.01,904.02,905.01,905.02,905.03,905.05,905.06,905.07,905.08,905.09,. Motion carried 6-0.

Cole Lewandowski moved, and Alyssa Reynolds seconded, to approve the Substitute Teacher Pay to \$160. Motion carried 6-0.

Alyssa Reynolds moved, and April Gross seconded to adjourn the meeting at 8:42 p.m. Motion carried 6-0.

The next regularly scheduled meeting of the Board of Education will be at 7:30 p.m. on September 15<sup>th</sup>, 2025, immediately followed by budget hearing at 7:00 p.m. The agenda is a continuous agenda and is available for examination during regular hours at the office of the Superintendent. Public notice of the meeting will be given in the Hallway Happenings Newsletter and in the Sherman County Times.

Marie Sweley  
Board Secretary

# September



2025

Sunday	Monday	Tuesday	Wednesday	Thursday	Friday	Saturday
	1 No school	2 Churro Goulash	3 Waffle Enchilada	4 Omelets Ham sandwich	5 Donuts Hot dogs	6
7	8 Muffin Lasagna	9 Hash brown quesadilla	10 Cinnamon rolls Hot pockets	11 French toast Chicken patty	12 Donuts Crispito	13
14	15 No school	16 Muffins Tator tot casserole	17 Pancakes Ribs	18 Apple strudels Pulled pork	19 Donuts Walking taco	20
21	22 Waffle Hamburgers	23 Muffins Popcorn chicken	24 Biscuit/gravy Nacho	25 Omelets Ravioli	26 Donuts Corndogs	27
28	29 Muffins Chicken nuggets	30 Waffle Meatball subs				

2025

## September

SUNDAY	MONDAY	TUESDAY	WEDNESDAY	THURSDAY	FRIDAY	SATURDAY
31	01 <b>No School Labor Day</b>	02 JV/V VB @ Shelton 5:30/6:30	03	04 JV/V VB Triangular v Twin Loup, and A-M @ Merna 5:00. CC @ Gibbon 5:30	05 FB v Silver Lake @ Bladen 7:00	06
07	08 JH VB/FB 4:00 JV VB/FB 5:30 @ Shelton	09 <b>FFA Husker Harvest Days</b> JH VB vs. Elm Creek @ Ansley 4:00. CC @ Loup City 5:30	10	11 JV/V VB v Axtell @ Litchfield 5:30/6:30	12 JH/JV FB 4:00/5:30 @ Elba	13 VB @ Seven Valleys Tourney (Callaway) 9:00a
14 <b>Homecoming Week</b>	15 <b>No School</b> Parent Teacher Conferences 4:00-7:00	16 JV/V VB v Central Valley, Arcadia-Loup City @ Greeley 5:00	17	18 JV/V VB v G.I. Lutheran @Litchfield 5:30/6:30. CC @ Ravenna 4:00	19 FB v Medicine Valley @ Ansley 7:00	20 JH VB @ Litchfield 9:00 JV VB @ Ansley 9:00
21	22 JH VB/FB 4:00 JV VB/FB 5:30 v SEM @ Ansley	23 <b>ASVAB Testing</b> JV/V VB v SEM @ Ansley 5:30/6:30	24 <b>FFA Ignite</b>	25 FB @ Shelton 7:00	26 JV/V VB 4:00/5:00 @ Ravenna. CC @ Ord 4:00	27 VB Spartan Invite @ Ansley 9:30
28	29 <b>HS to Merryman for "The Outsiders"</b> JH VB v Ravenna 4:30 @ Litchfield. JH FB v G.I. Lutheran 4:30 @ Litchfield. CC @ UNK 12:00	30 <b>FBLA FLC Conference</b> Reserve/JV/V VB v South Loup @ Callaway 5/6/7	01	02	03	04
05	06	Notes:				



## **Zelle - Pay lunch bills online!**

Instead of just cash and checks brought into the office, you can now use your bank's website or app to digitally send payments in any amount, and even schedule for a later date or schedule an autopay (e.g. x amount every month). There is no fee, initial set up is very easy, and sending subsequent payments is even easier.

The only requirement is that your bank offers Zelle payments. Most, including Town & Country Bank, do. And thank you to Town & Country for reaching out and helping us set this up!

**1. To get started, go to your bank's website or app.** Then find the Zelle section (might also say Bill Pay or Send a Payment).

**2. Then add Litchfield as a recipient.** Depending on your own phone and bank, you can scan the QR code below, or simply click Add Recipient on your bank's site/app, name the recipient Litchfield and put in lunch@litchfieldps.org for the email address.

**3. Decide how much to pay and send.** You can refer to the weekly text/email for your kid(s) current amount, or check Powerschool. There is an Add a Memo box where you can include a message for the office, like "add \$x.xx to one kid's account and \$x.xx to the other."

Done! The payment is sent instantly. It will be reflected on Powerschool and the text/email messaging after the office processes it shortly.

Send Money with Zelle®  
Scan in your banking app to pay



**zelle**

## Parents and Guardians:

Are you receiving all the right communications from the school?

**Text Messages: To make sure you are getting important text messages, text “Yes” to 79041 AND/OR**

### **[Recommended] Download and log in to the Parent Hub app**

1. Download **BrightArrow ParentHub** from the Apple App store or Google Play store.
  - The all-in-one messaging where you can also receive and send questions with teachers.
  - Be sure to search the whole app name and find the one with the right logo.
2. Click on the Sign Up link at the bottom.
3. Select the type of account you will be using by clicking on Parent / Student.
4. Enter either an email address or phone number that the school has on file for you.
5. Create a password (must be at least 8 characters in length and contain at least one digit).



**LITCHFIELD PUBLIC SCHOOLS  
500 N MAIN ST  
LITCHFIELD, NE 68852**

**Presorted Standard  
Postage Paid  
Litchfield Public Schools  
Permit #2**

**POSTAL CUSTOMER**